

Washington Street Dermatology

Interior Map

Use the Washington Street entrance. Then, walk to the back of the main lobby until you get to the elevators that service floors 12 to 21, located at the back of the lobby. Take an elevator to floor 18.

After you exit the elevator, Suite 1801 is to the left.

There are security desk personnel stationed near the Washington Street entrance in the main lobby, they can answer any questions.

Washington Street entrance

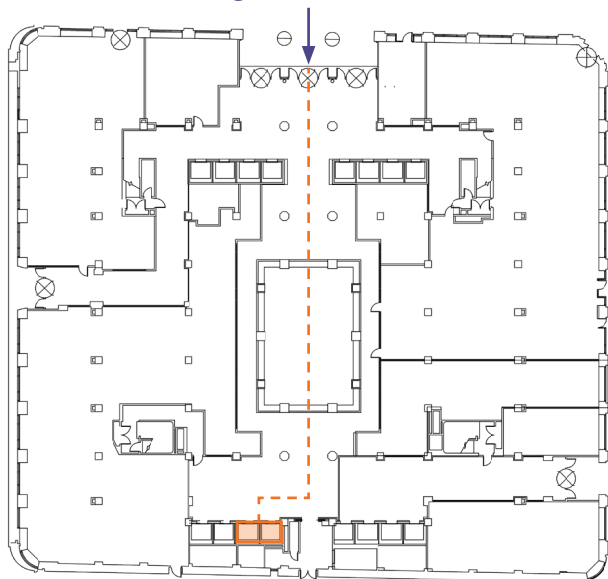

Floor 18

